



# Silver Spring

CAT Meeting #3

October 25, 2018



## Carla Julian

PLTC Sr. Manager Public  
Affairs/Community Outreach

## Jim Jewell

PLTC Area 1 Manager



## MEETING OVERVIEW

- Construction Overview
  - Progress Pictures
- Silver Spring International Middle School
- Wayne Ave.
- Bonifant St. Update
- Construction Work Hours
- Maintenance of Traffic & Pedestrian Safety
- Community & Business Outreach
- Questions & Answers



## SILVER SPRING CAT SEGMENT

Spring St. to Wayne Ave. to Manchester Place Station

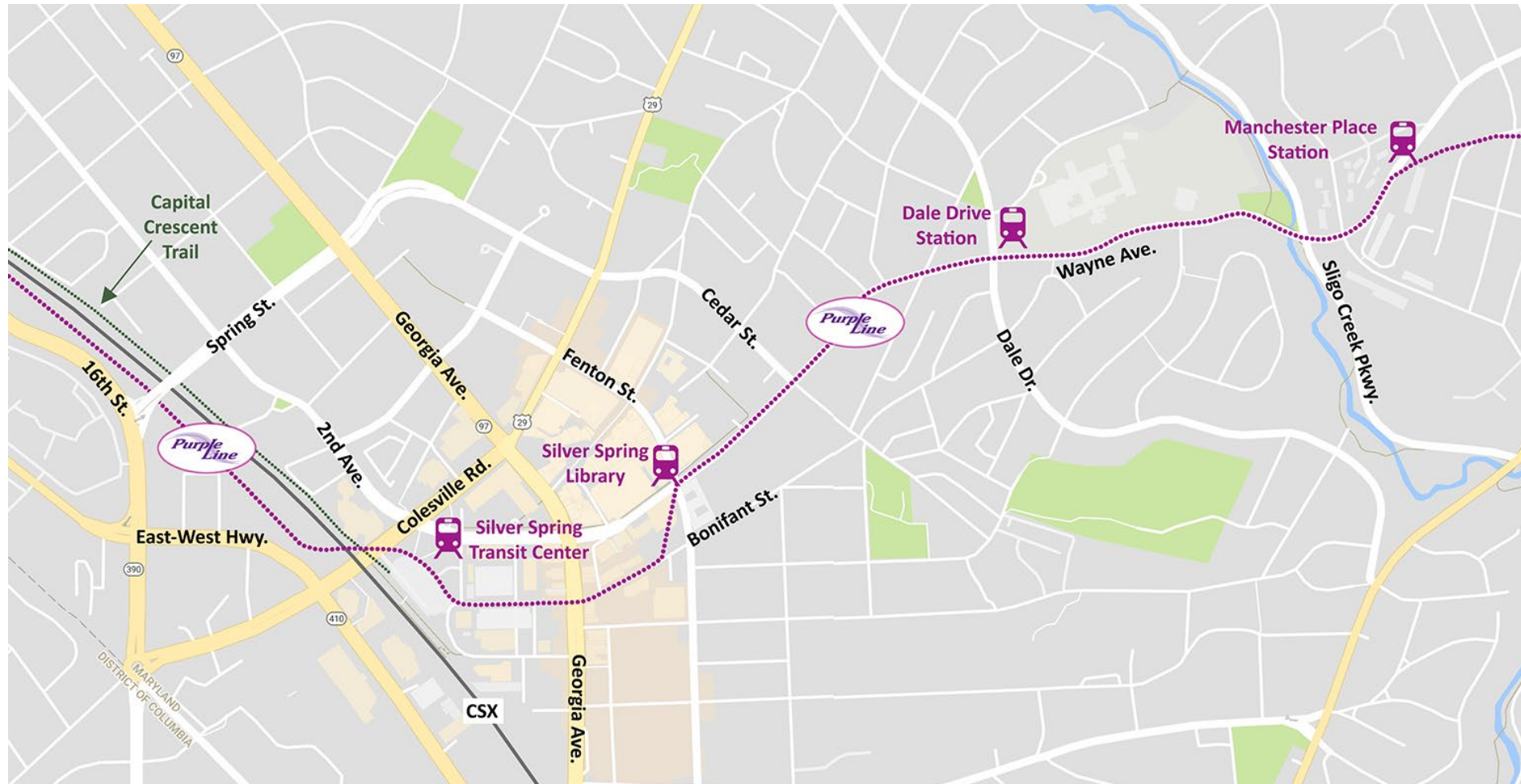





## COMPLETED/ONGOING CONSTRUCTION WORK

- Segment Wide:
  - Utility relocation work ongoing
  - Erosion and sediment controls installed
  - Stormwater management for construction installed
  - Tree clearing ongoing
- 16<sup>th</sup> St. Plaza demolition ongoing
- Rite Aid/FedEx Kinkos demolition ongoing
- Silver Spring International Middle School site work ongoing







## PROGRESS PHOTOS

- Silver Spring International Middle School site work







## PROGRESS PHOTOS

- Demolition of Spring Street Shopping Center







## PROGRESS PHOTOS

- Demolition of Spring Street Shopping Center







## PROGRESS PHOTOS

- Demolition of Rite Aid and FedEx Kinkos on East-West Hwy.





## 6-MONTH LOOK AHEAD

- Segment Wide:
  - Overhead utility work
  - Underground utility work
- Bonifant west closure (winter 2019)
- Begin foundation construction for the bridges over Colesville Rd. (winter 2019)
- Begin work on Silver Spring Transit Center (winter 2019)
- Ongoing work at Silver Spring International Middle School (complete summer 2020)
- Sligo Creek Park - storm drain outfall work (fall 2018/winter 2019)
  - Waiting on park permit and final plans to be released for construction
  - Permit requires we cannot work in Sligo Creek between March and June

\*Schedule subject to change





## SILVER SPRING TRANSIT CENTER – WINTER 2019

- **Start work winter 2019**
- Prior to the start of work, a work zone and temporary pedestrian plan will be established
  - Pedestrian access will be maintained across Colesville Rd.
- Start foundations for light rail track and Capital Crescent Trail bridges over Colesville Rd.

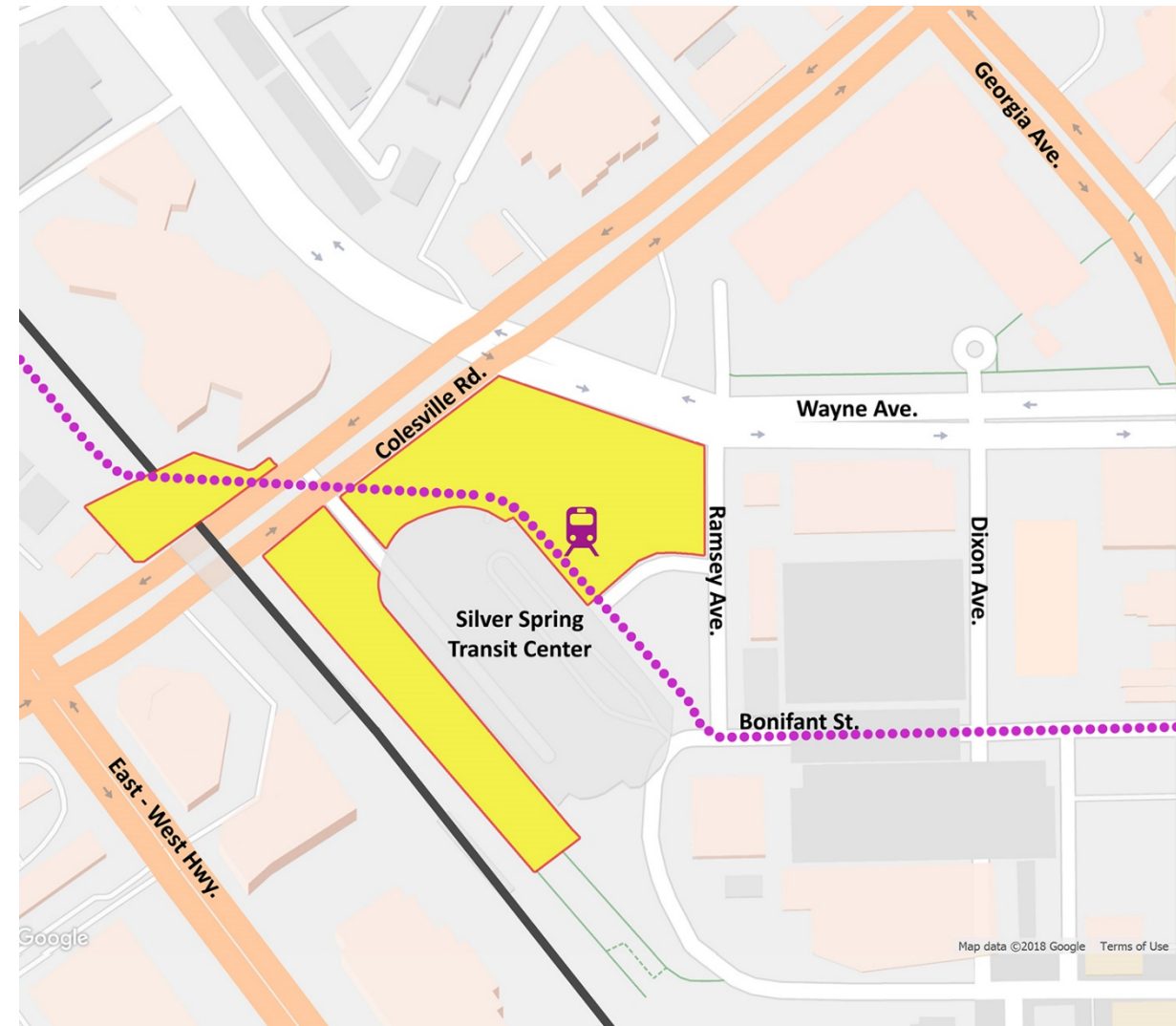





Work Zone:   
No pedestrian access

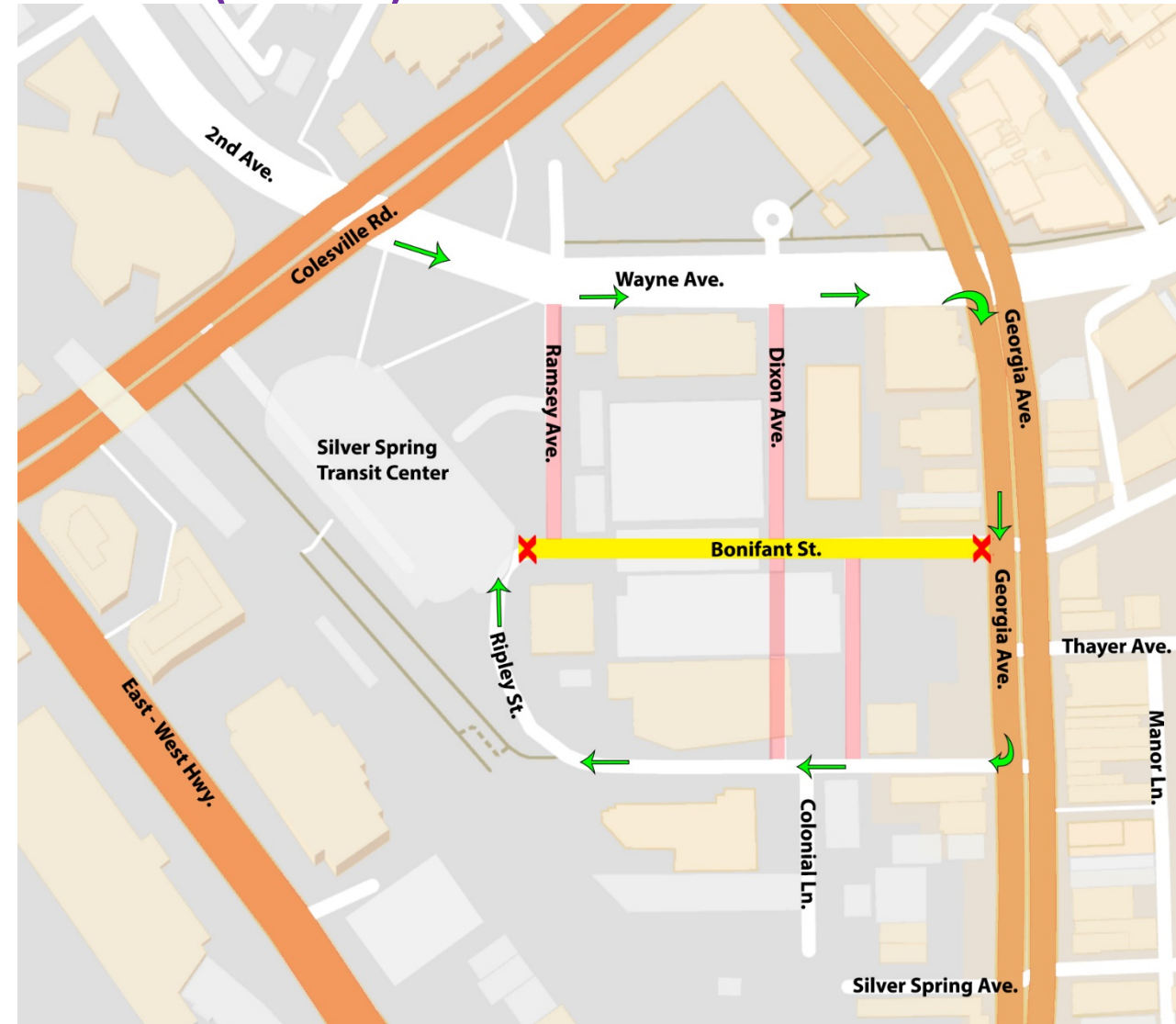

## WEST BONIFANT ST. DETOUR – WINTER 2019 (2 YEARS)

- Closure remains in place until all utilities are relocated
- Once it reopens, Bonifant St. will be a one-way street heading toward the Silver Spring Transit Center (westbound)
- Local access maintained for parking garages and office buildings



Local Access Only:	
Thru Traffic Detour:	
Work Zone:	
Road Closure:	





## WEST BONIFANT ST. CLOSURE – WINTER 2019

- Local access maintained for parking garages and office buildings

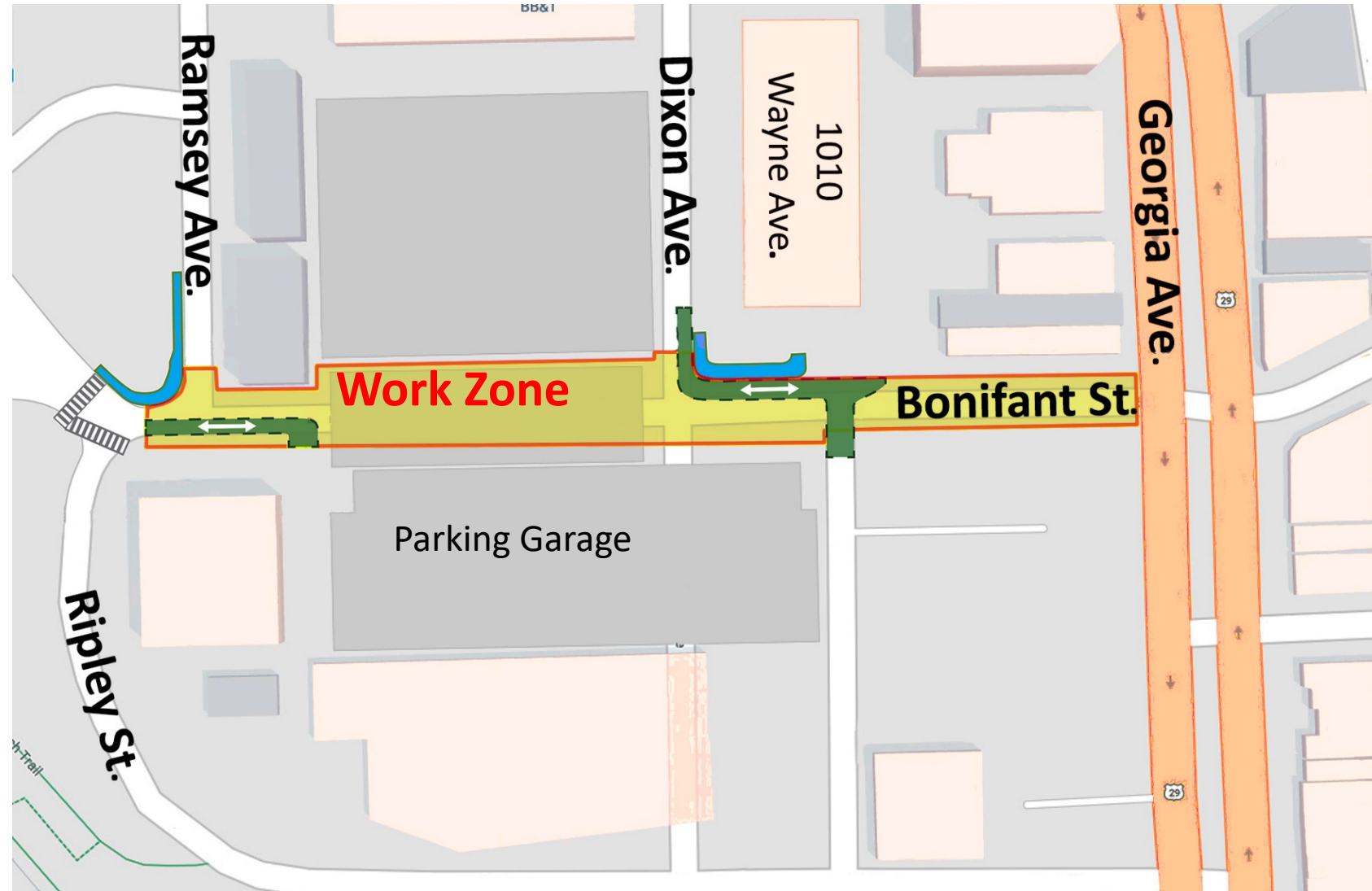
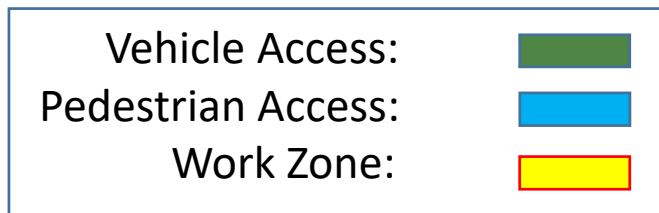



## SILVER SPRING TRANSIT CENTER DESIGN RENDERING







## SILVER SPRING TRANSIT CENTER DESIGN RENDERING (continued)

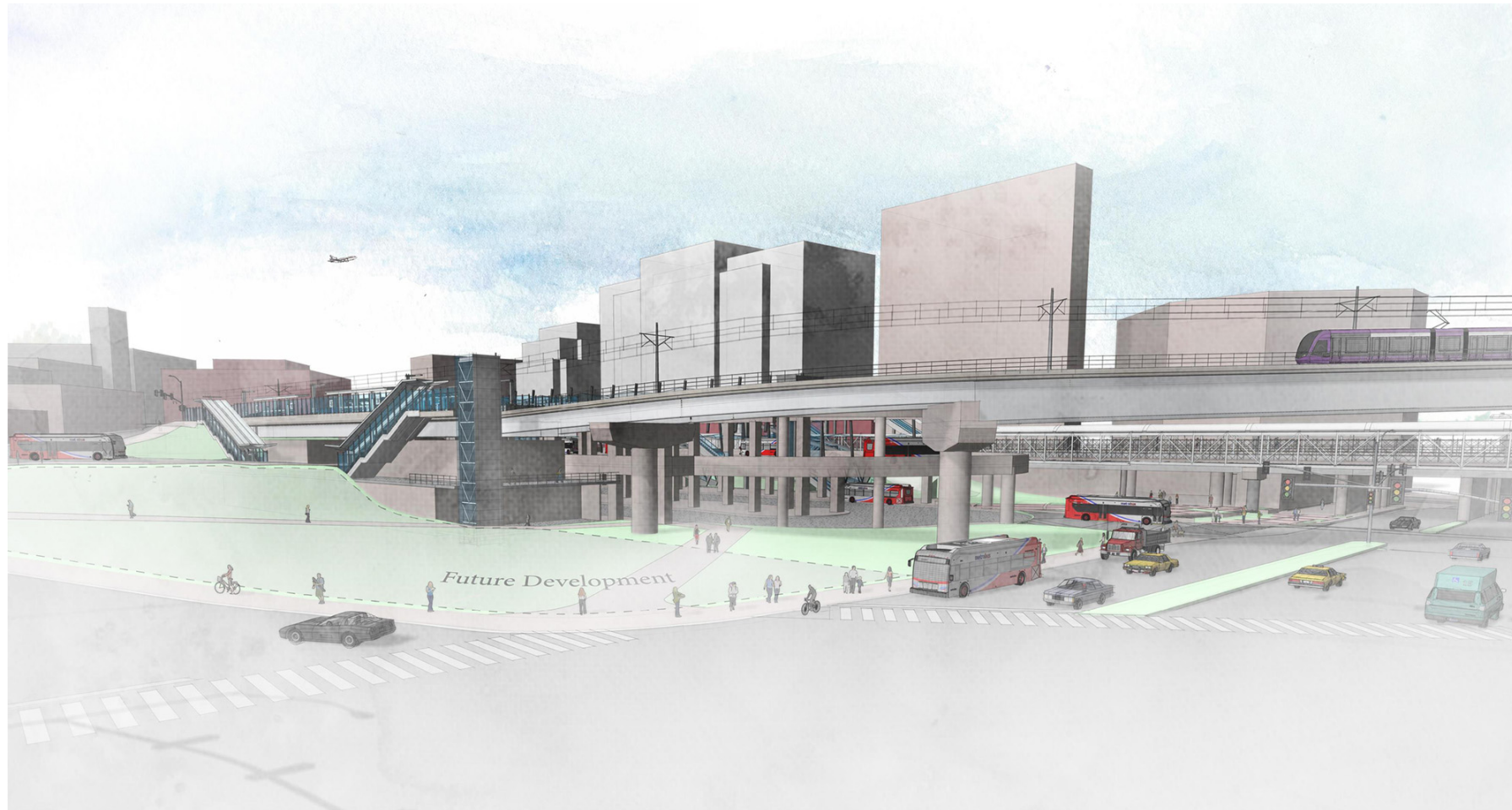







## WAYNE AVE.

- **Winter 2018/2019**
- Stormwater outfall work
- Overhead power relocation (requires intermittent, day-time lane closures)
- Pedestrian access will be maintained

Pedestrian Access:   
Pedestrian Walkway:   
Work Zone: 

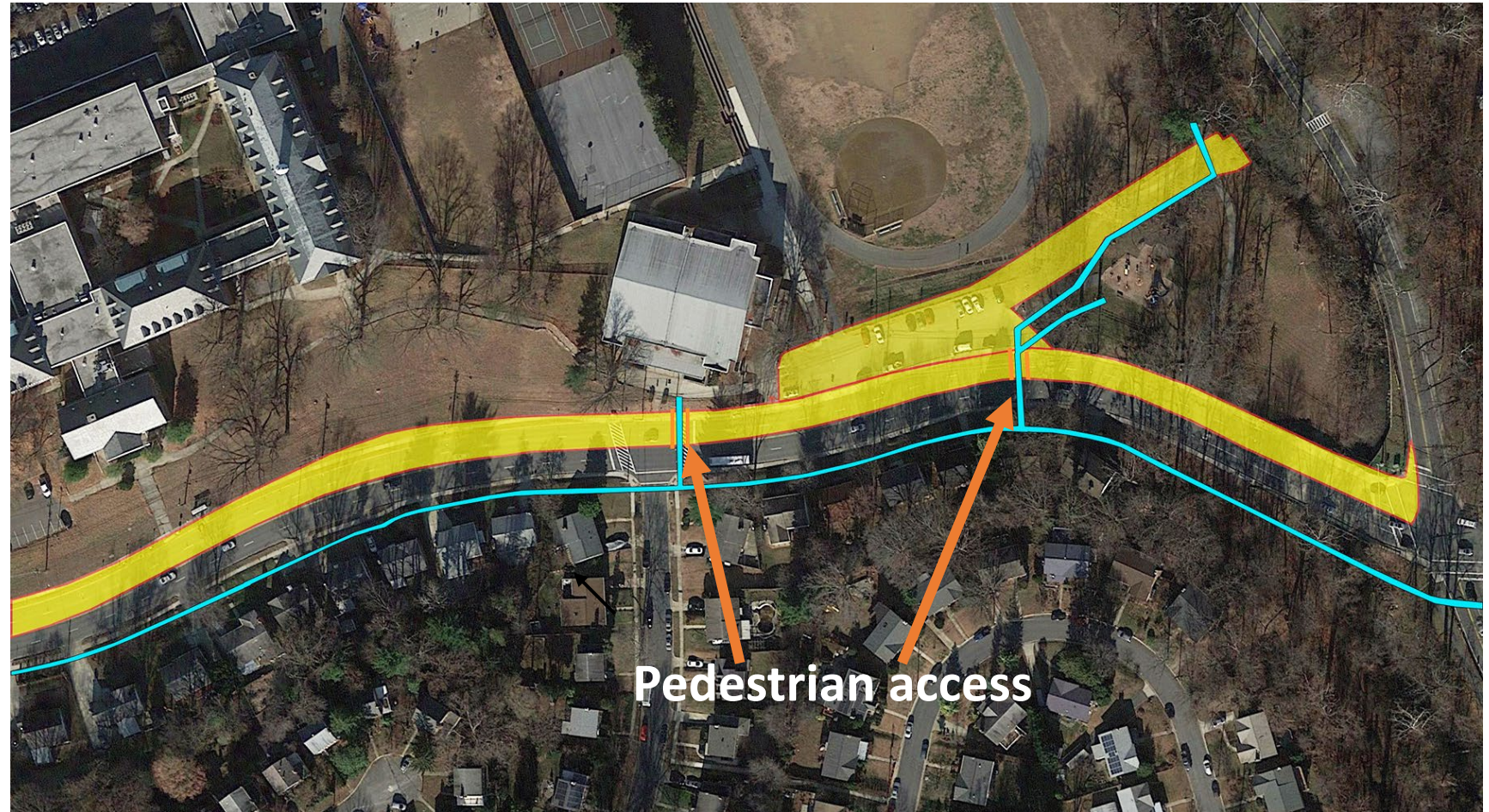

Pedestrian access



\* Two lanes of traffic will remain open at all times on Wayne Ave.





## SILVER SPRING INTERNATIONAL MIDDLE SCHOOL: 2018 - 2020

- Work Zone 1:
  - Cleared
  - Installed Drainage
  - Added new driveway entrance
- Work Zone 2:
  - Cleared
  - Installed Drainage
  - Upcoming work:
    - Install retaining walls

Pedestrian Access:   
Pedestrian Walkway:   
Work Zone: 

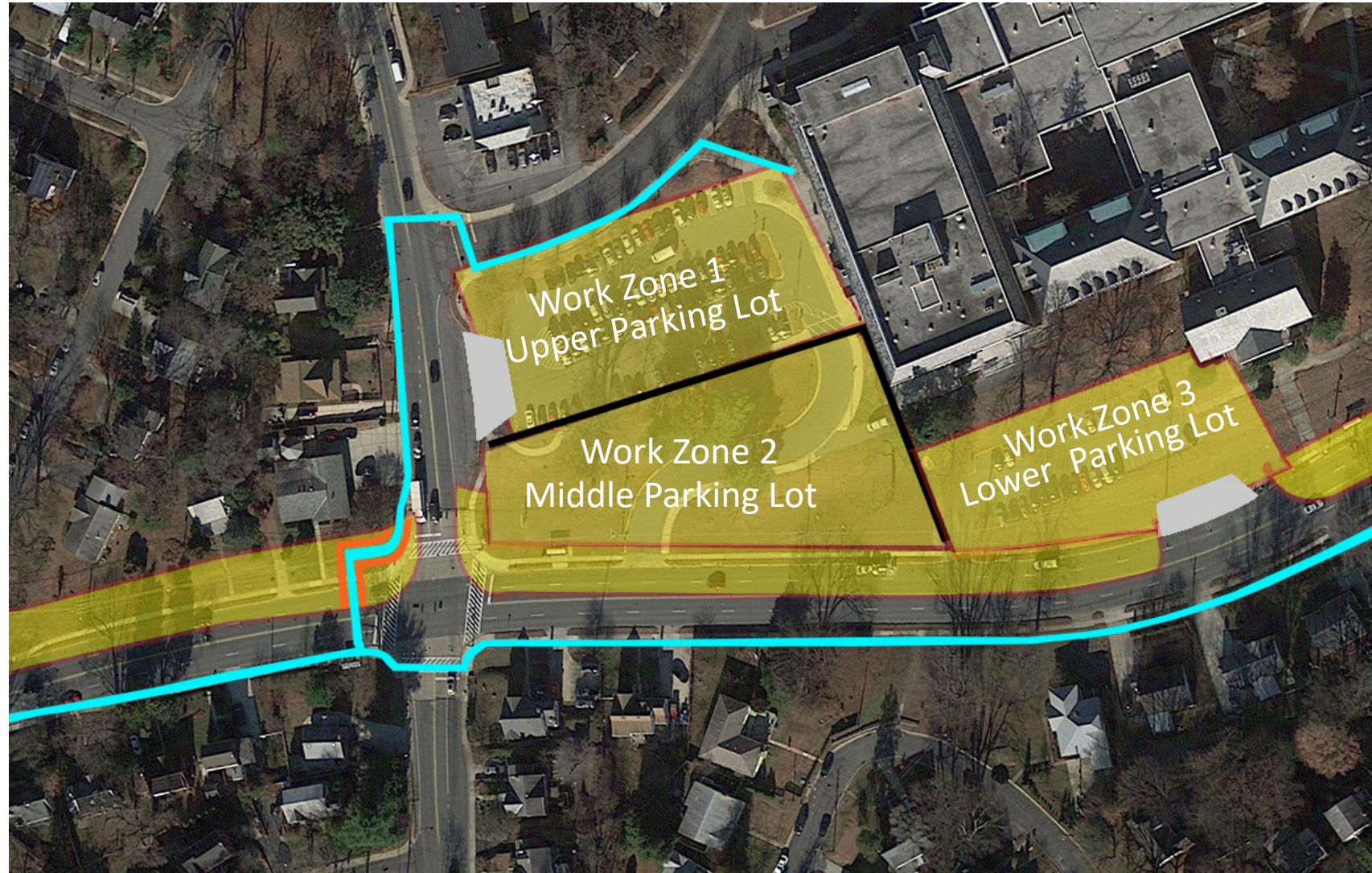









## SILVER SPRING INTERNATIONAL MIDDLE SCHOOL

- School Year 2018 -2019

Pedestrian Access:	
Pedestrian Walkway:	
Work Zone:	
Open School Parking:	











## SILVER SPRING INTERNATIONAL MIDDLE SCHOOL

- Summer 2019

Pedestrian Access:	
Pedestrian Walkway:	
Work Zone:	
Open School Parking:	







## MAINTENANCE OF TRAFFIC – WHAT TO EXPECT

- Existing traffic patterns will change as work occurs, as needed
- Work may occur on both sides of the road and across roadways
- When a lane closure is required, a notice will be distributed via text and email (sign-up required through [purplelinemd.com](http://purplelinemd.com))
- Orange cones and barrels (temporary barricades) will be in place
- Flag-person, when required, will direct traffic
- Underground utility work may require temporary road plates







## PEDESTRIAN SAFETY

- Work zones will be clearly marked and the public should not enter them
- Pedestrian detours will be clearly signed
- When closures occur, alternate access will be provided
- Pedestrian crossings will be maintained
- ***Pedestrians should obey construction signage and keep out of work zones***





## COMMUNITY & BUSINESS OUTREACH

- Sponsored *Taste the World in Fenton Village*
- Sponsored redevelopment of *Discover Bonifant* website
- Working with County to fund branded *Discover Bonifant* “Open During Construction” signage
- Working with individual businesses to find creative ways to generate business during construction
- Using local vendors to provide signage and PLTC “giveaways”



PLTC sponsored the *Taste the World in Fenton Village* and staff was on hand to answer all construction questions from the community.





## COMMUNITY & BUSINESS OUTREACH (continued)

- Sponsoring SSIMS Outdoor Education (STEM) Program
- Meeting with Bonifant businesses and Silver Spring Urban District on regular basis
- Working with businesses impacted by construction on an individual basis
- Vehicle, pedestrian and delivery access to all businesses will be maintained during construction
- Outreach efforts are coordinated in English and Spanish, as needed
- Tailored construction updates will be provided to impacted businesses



PLTP/PLTC is partnering with SSIMS Outdoor Education Program to raise funds, provide staff and resources to support the STEM program.





## CONSTRUCTION WORK HOURS

- Standard work week is 40 hours
- Make-up / maintenance day will be Saturdays as required
- Typical day shift: 7 a.m. – 5 p.m.
- Typical night shift: 8 p.m. – 4:30 a.m.
- Typical traffic lane closure: 9 a.m. – 3 p.m.

Public will be notified through notifications on [purplelinemd.com](http://purplelinemd.com) for:

- Night work
- Weekend work
- Major lane closures
- Utility shutdowns
- Road/driveway closures
- Blasting/pile driving

The screenshot shows the 'PURPLE LINE TRANSIT PARTNERS CONSTRUCTION INFORMATION' website. The header features the Purple Line logo and a navigation bar with links: Home, About the Project, Public Involvement, Construction, Community Advisory Teams (CATs), Kids Page, and Contact Us. A 'Select Language' dropdown is also present. Below the navigation bar, there are three images showing construction activities: a large excavation site, a worker in a high-visibility vest, and a construction site with cranes. To the right of these images are four buttons: 'For Construction Inquiries Call 240-424-5325', 'For Emergencies Please Call 911', 'Subscribe For Updates In English', and 'Subscribe For Updates In Spanish'. Below the images is a section titled 'Construction Info' with a paragraph of text: 'The Purple Line project is a new 16-mile east-west light rail line that operates mostly on the surface with 21 stations and connects New Carrollton in Prince George's County and Bethesda in Montgomery County. It also provides a direct connection to four Washington Metrorail lines, three MARC commuter rail lines, Amtrak Northeast Corridor and regional and local bus services.'



## STAY UP TO DATE ON PURPLE LINE PROGRESS

- Sign up for construction notices at [purplelinemd.com](http://purplelinemd.com)
- For construction-related questions and concerns, contact PLTP:
  - Email at: [outreach@pltcllc.com](mailto:outreach@pltcllc.com)
  - 24/7 hotline at **240-424-5325**
- For general project questions and comments, contact MTA public outreach:
  - Email at: [outreach@purplelinemd.com](mailto:outreach@purplelinemd.com)
  - Call: **443-451-3706** or **443-451-3705 (Español)**