



# Silver Spring

CAT Meeting #4

June 11, 2019



## **Mike Madden**

MDOT MTA Purple Line Deputy Project Director

## **Carla Julian**

PLTC Sr. Manager

Public Affairs/Community Outreach

## **Jim Jewell**

PLTC Area 1 Manager



# MEETING OVERVIEW

- **Purple Line Project Update**
  - Art-in-Transit
- **Construction Progress Overview**
  - Work Completed
  - Progress Photos
  - 6-Month Look Ahead
- **Silver Spring Transit Center**
- **Maintenance of Traffic & Pedestrian Safety**
- **Construction Work Hours**
- **Business Outreach**
- **Updated Purple Line Website**
- **Questions & Answers**



# SILVER SPRING CAT SEGMENT

Stations in this segment:

- Silver Spring Metro
- Silver Spring Library
- Dale Drive

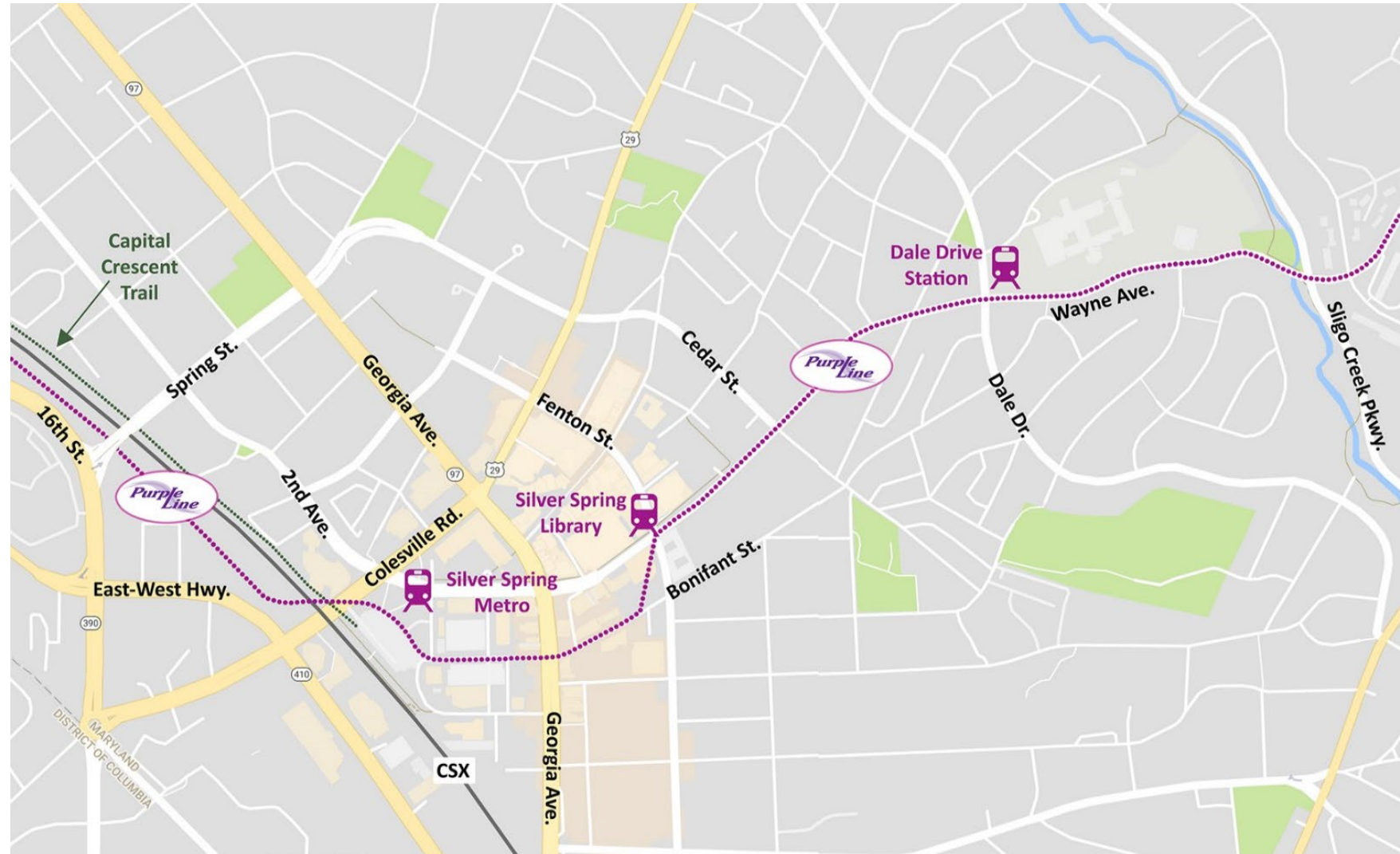





## PURPLE LINE PROJECT UPDATE

- The Purple Line is being delivered as a Public-Private Partnership (P3) to finance, design, construct, operate, and maintain
- Construction is underway throughout the 16.2-mile corridor
  - Design: 85% complete
  - Construction: 15% complete
- Right-of-way acquisitions are nearing completion
- MDOT MTA's goal is for service to begin late 2022



## ART-IN-TRANSIT

- The mission of the Purple Line Art-In-Transit program is to make public art an integral element of the project.
- Art will be incorporated into stations to enrich the aesthetics of the light rail system and support neighborhood identities.
- Artists have been selected, art proposals have been refined based on input received, and contracts are being negotiated.
- Artwork will be installed in its respective locations between 2020 – 2021.



# SELECTED ARTISTS

Selected Artist: **Martha Jackson-Jarvis**

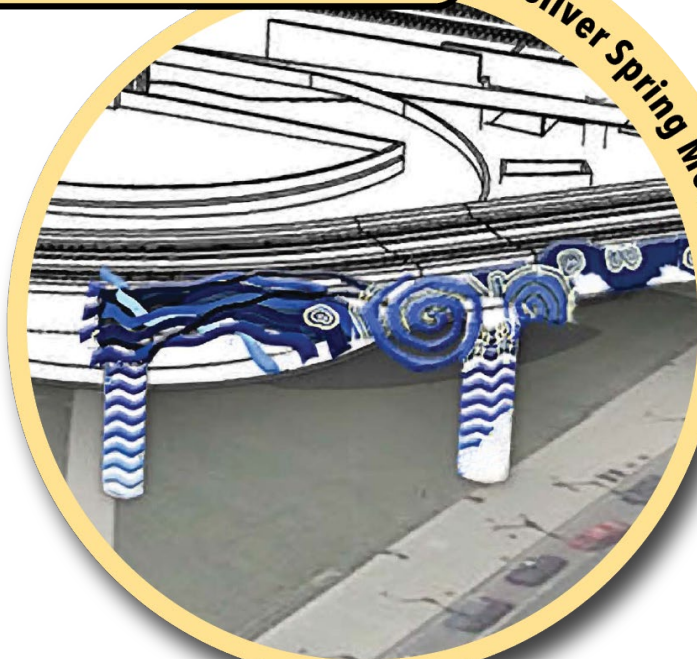

Silver Spring Metro Station

Selected Artist: **Andrea Dezzo**



Silver Spring Library Station

Selected Artist: **Susan Zoccola**



Dale Drive Station





## SILVER SPRING METRO STATION

The theme of this artwork is “Enchanted Spring” represented by a symbolic spiral that is iconic, familiar, and recognizable as an element of water, an oasis of growth, that signifies the continuous spiral of creativity and ingenuity that intertwines Silver Spring’s past legacy with its future growth. Selected materials of stainless steel, galvanized and painted, powder coated steel and glass mosaic and stone materials will form streams of energy, color, and reflection.

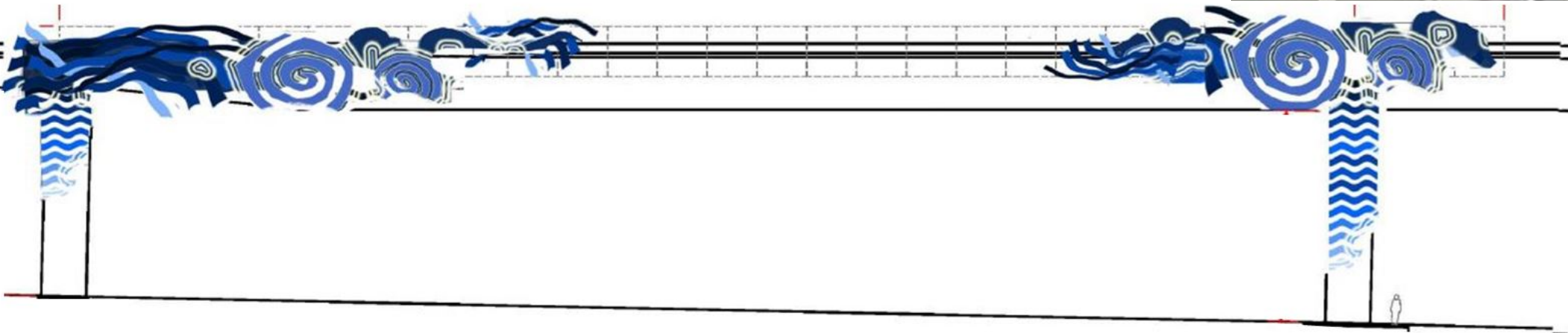





## SILVER SPRING LIBRARY STATION

The theme of this artwork is “A journey with books”. A series of silhouette images will be cut into metal panels to form an art fence that will run the length of the platform at the Silver Spring Library station. The artwork will be viewable from the pedestrian platforms, the library, and every approach to the station by cars, buses, bikes, and pedestrians on the surrounding streets. Each panel depicts the silhouette of the pages of an open book coupled with an element of nature associated with the seasons.



WINTER

SPRING

SUMMER

AUTUMN

WINTER



## DALE DRIVE STATION

This artwork is inspired by the parkland around Sligo Creek near the future Dale Drive station. Native trees of Sligo Creek will be represented in the glass art panels in the station shelter. Additionally there will be steel artwork on the retaining wall to further enhance the area representing the creek. Just like in nature, the trees and the creek create a peaceful and synergistic relationship that people enjoy being around year-around.





## WORK CONDUCTED OVER THE PAST 6 MONTHS

- Segment-wide
  - Utility relocation work
  - Installation of erosion and sediment controls
  - Installation of stormwater management facilities for construction
  - Tree clearing
- 16<sup>th</sup> Street (from Spring Street to Colesville Road)
  - Completion of the demolition of Rite Aid/Fed Ex buildings and foundations
  - Falkland Apartments asbestos abatement and utility disconnections in preparation for demolition
- Colesville Road
  - Test pitting for pier construction
  - Installation of drilled shafts for Light Rail Transit (LRT) bridge abutment construction
  - Extensive coordination with Silver SM property owner





## WORK CONDUCTED OVER THE PAST 6 MONTHS (CONTINUED)

- Silver Spring Transit Center
  - Extensive coordination with WMATA and Montgomery County
  - Mobilization of Work Zones adjacent to the Silver Spring Transit Center
- Wayne Avenue
  - Tree clearing and survey work
- Silver Spring International Middle School
  - Installation of retaining wall for middle parking area (Phase 1 completed)
  - Installation of storm drain system
  - Tree clearing at Sligo Creek for utility relocations



## 16<sup>TH</sup> STREET PROGRESS PHOTO

- 16th Street Staging Yard







# SILVER SPRING INTERNATIONAL MIDDLE SCHOOL PROGRESS PHOTO

- Installation of soldier pile retaining wall at SSIMS middle parking lot







## 6-MONTH LOOK AHEAD

- Segment-wide
  - Utility relocation work continues
  - Installation of erosion and sediment controls continues
  - Installation of stormwater management facilities for construction continues
  - Tree clearing ongoing
- 16<sup>th</sup> Street (from Spring St. to Colesville Rd.)
  - Drilled shaft installation for the support of excavation (SOE) piles
  - Falkland Apartments unit demolition



## 6-MONTH LOOK AHEAD (CONTINUED)

- Colesville Road
  - Capital Crescent Trail (CCT) bridge abutment construction
  - LRT bridge abutment construction
  - CCT bridge erection
  - LRT and CCT pier construction
- Silver Spring Transit Center
  - New traffic pattern for buses will be established by WMATA
  - Extensive coordination with WMATA and Montgomery County continues
  - Work Zones detailed further on following slides



# SILVER SPRING TRANSIT CENTER WORK ZONE

- Fencing will be installed to create long-term Work Zones began June 11, 2019
- Mobilization of materials will occur following installation of fencing
- Foundations for light rail track and CCT bridges over Colesville Road will begin in Summer of 2019

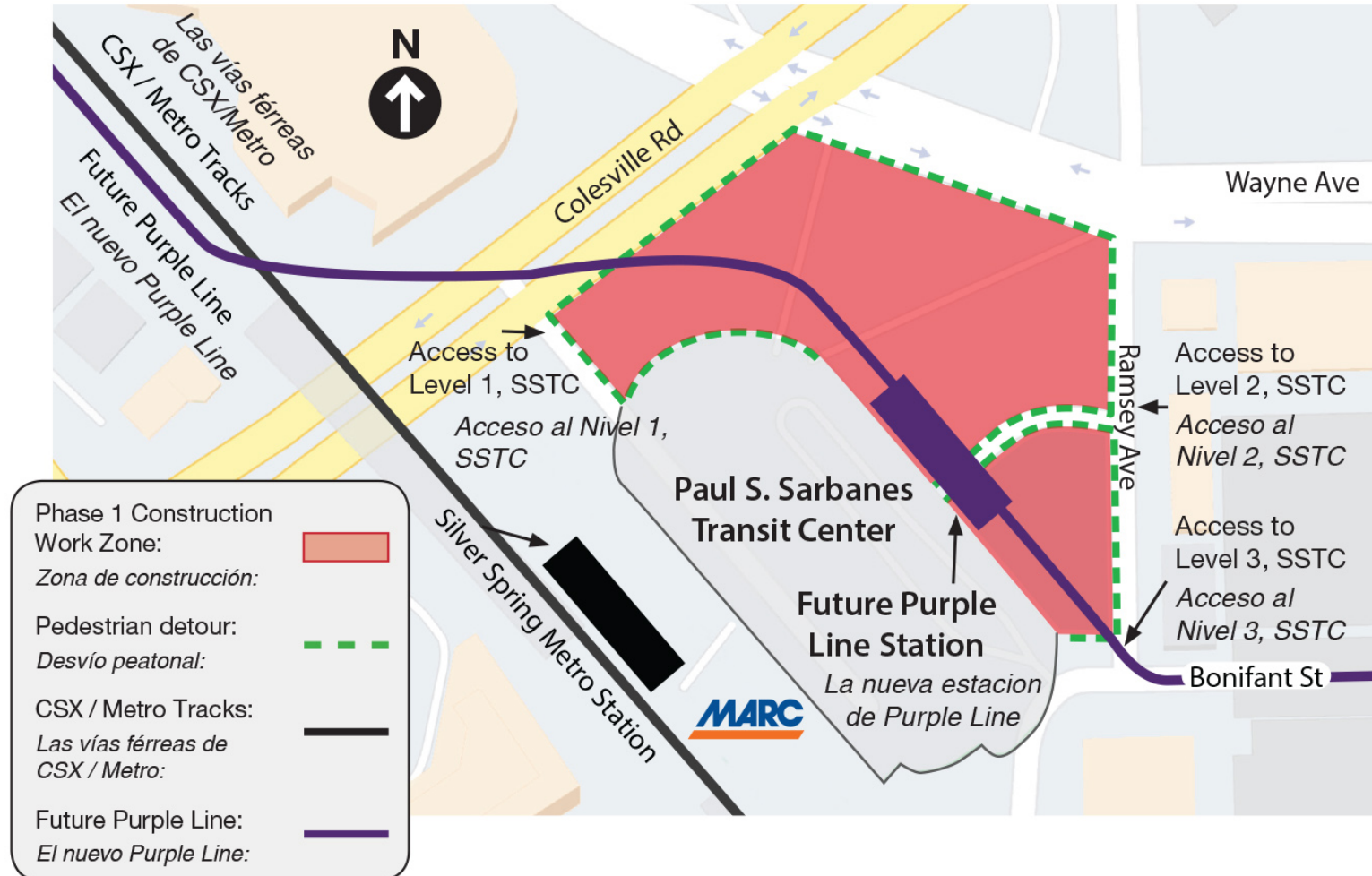





## 6-MONTH LOOK AHEAD (CONTINUED)

- Bonifant Street
  - New traffic patterns will be implemented, detailed further on following slides
    - West Bonifant closure for utility relocations (Fall 2019)
    - East Bonifant traffic shift for utility relocations (Fall 2019)



## WEST BONIFANT STREET LONG-TERM CLOSURE – SUMMER/FALL 2019

- Closure will remain in place until all utilities are relocated (approx. 2 years)
- Once reopened, Bonifant St. will permanently be a one-way street heading toward the Silver Spring Transit Center (westbound)
- 30-day notice will be provided via PLTC's notification system

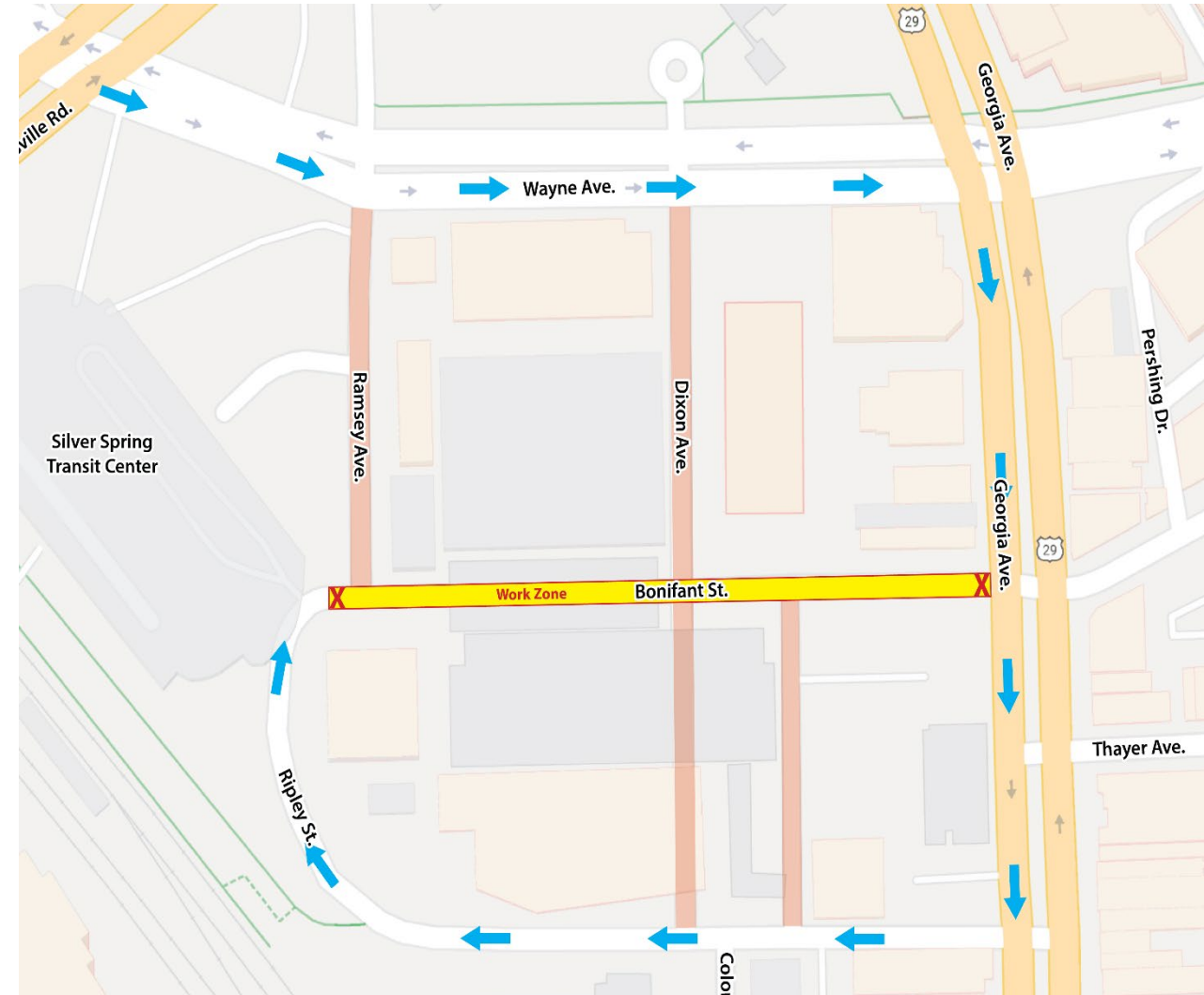
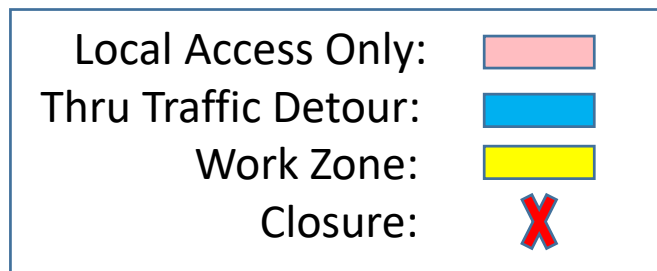



## WEST BONIFANT STREET LONG-TERM CLOSURE – LOCAL ACCESS

- Local access will be maintained for pedestrian and vehicular traffic to parking garages and surrounding buildings

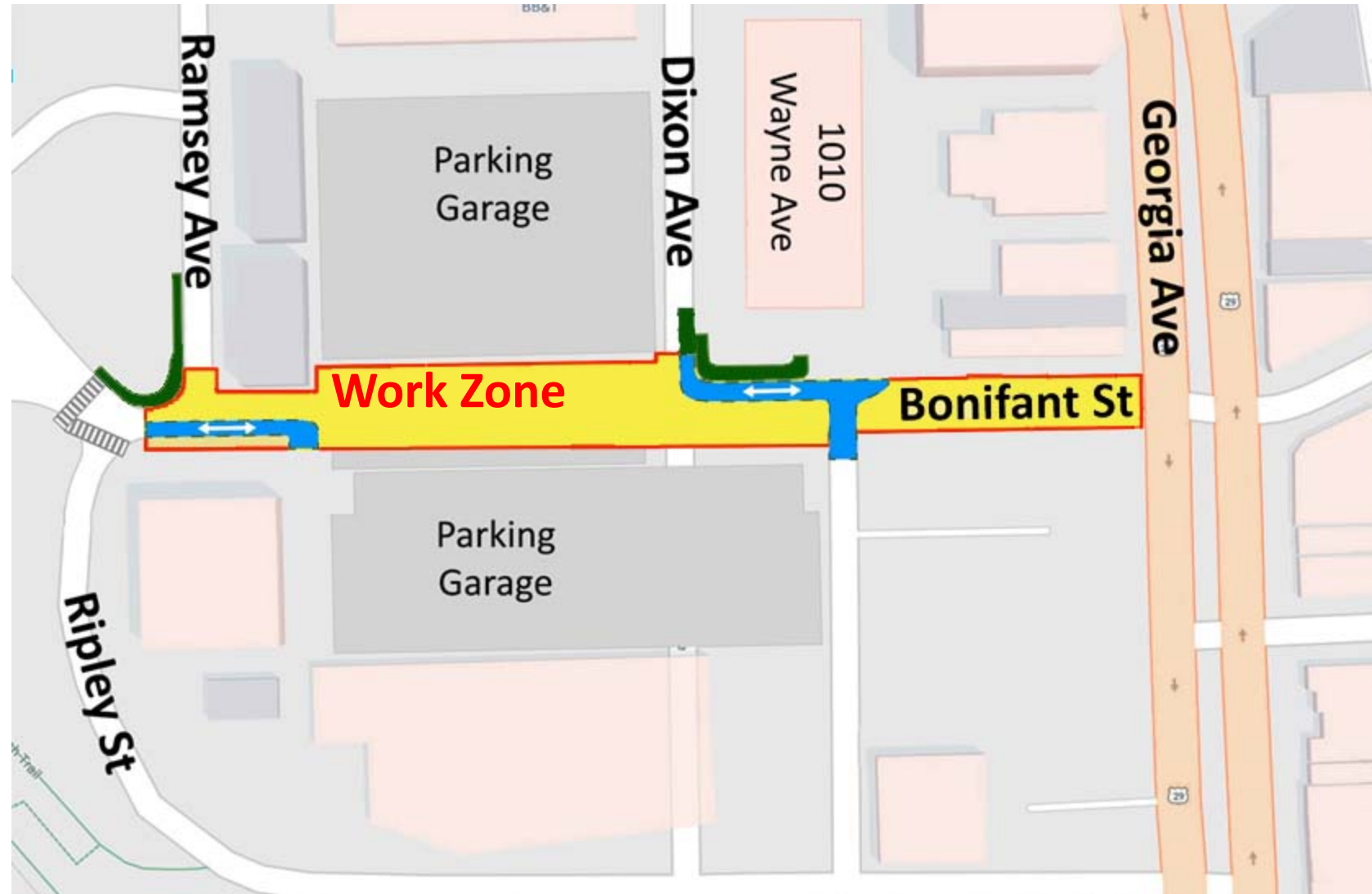
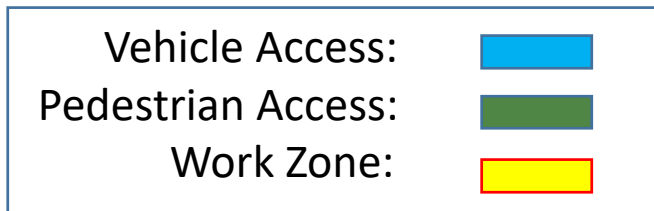









## EAST BONIFANT STREET LONG-TERM PARTIAL CLOSURE – SUMMER/FALL 2019

- East Bonifant will operate as a one way street eastbound
- Westbound direction will be closed as a Work Zone
- There will be pedestrian walkways with safety fencing to separate Work Zone from pedestrians
- Local access to businesses will be maintained

Vehicle Access:	
Pedestrian Access:	
Work Zone:	
Closure:	

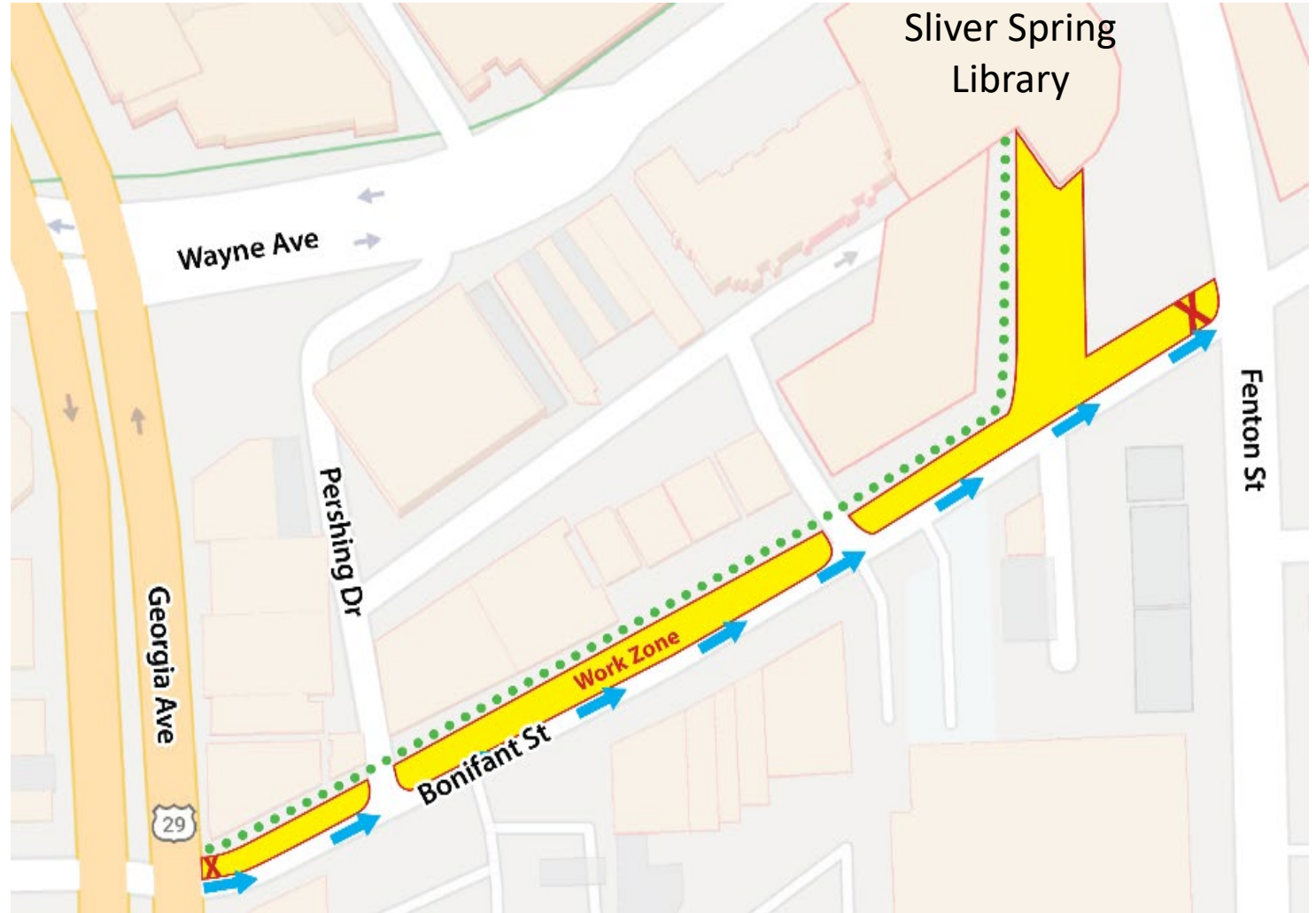



## 6-MONTH LOOK AHEAD (CONTINUED)

- Wayne Avenue
  - Installation of storm drain
  - Installation of cast-in-place retaining walls



## WAYNE AVENUE WORK ZONE

- A Work Zone on the north side of Wayne Avenue (between Dale Dr. and Sligo Creek Pkwy.) will be established to facilitate utility relocations and drainage facilities
- Work to begin mid-late Summer 2019

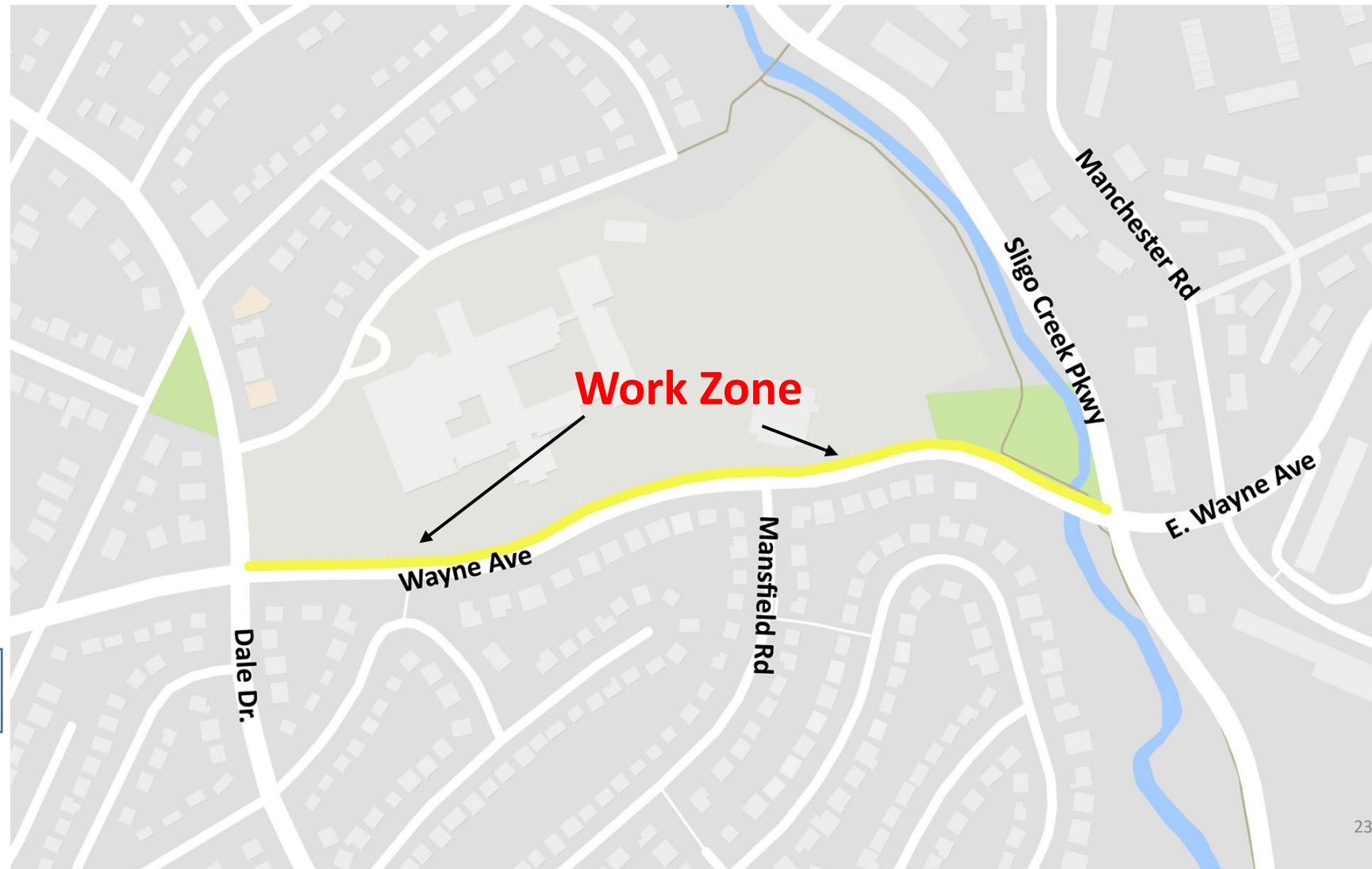

Work Zone: 





## 6-MONTH LOOK AHEAD (CONTINUED)

- Silver Spring International Middle School (SSIMS)
  - Demolition of existing paving in the upper parking lot (Summer 2019)
  - Storm drain installation
  - Installation of retaining walls in the upper and middle parking lots (Summer 2019)
  - Installation of permanent curb and gutter, sidewalk and paving of the upper and middle parking lots (Summer 2019)
- With the exception of the storm drain installation work, all construction activities at SSIMS will be limited to summer months while school is not in session
  - Work will take place in two shifts, from 7 a.m. to 5 p.m. and from 5 p.m. to 10 p.m. on weekdays and weekends



# SILVER SPRING INTERNATIONAL MIDDLE SCHOOL WORK ZONES

- Construction of the parking lots to be complete prior to the beginning of the 2019 school year
- Pedestrian walk ways will be maintained

Pedestrian Walkway:



Work Zone:

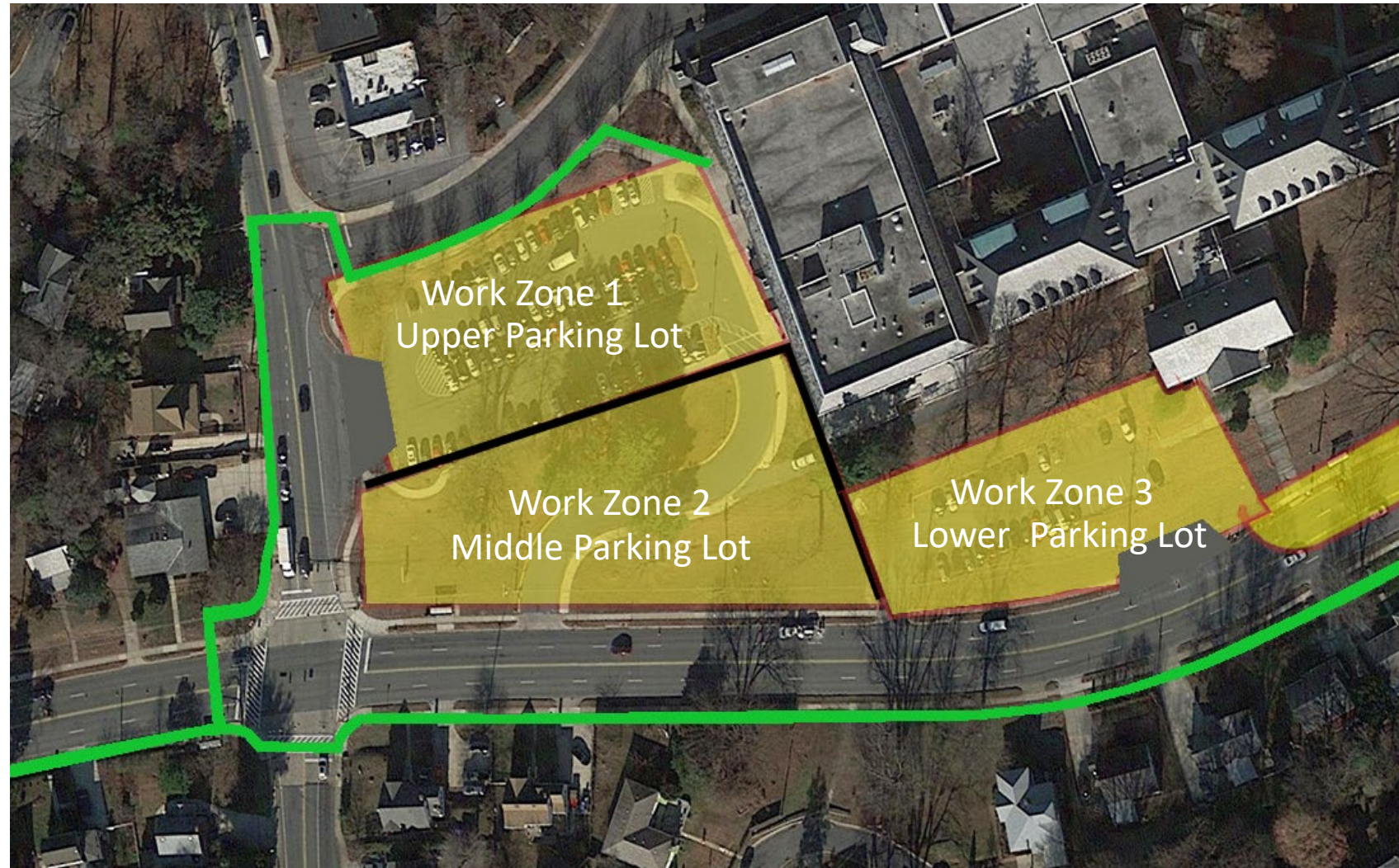





## MAINTENANCE OF TRAFFIC – WHAT TO EXPECT

- Existing traffic patterns will change as work occurs, as needed
- Work may occur on both sides of the road and across roadways
- When a lane closure is required, a notice will be distributed via text and email (sign-up required through [purplelinemd.com](http://purplelinemd.com))
- Orange cones and barrels (temporary barricades) will be in place
- Flag-person, when required, will direct traffic
- Underground utility work may require temporary road plates







## PEDESTRIAN SAFETY

- Work Zones will be clearly marked and the public should not enter them
- Pedestrian detours will be clearly signed
- When closures occur, alternate access will be provided
- Pedestrian crossings will be maintained
- ***Pedestrians should obey construction signage and keep out of Work Zones***

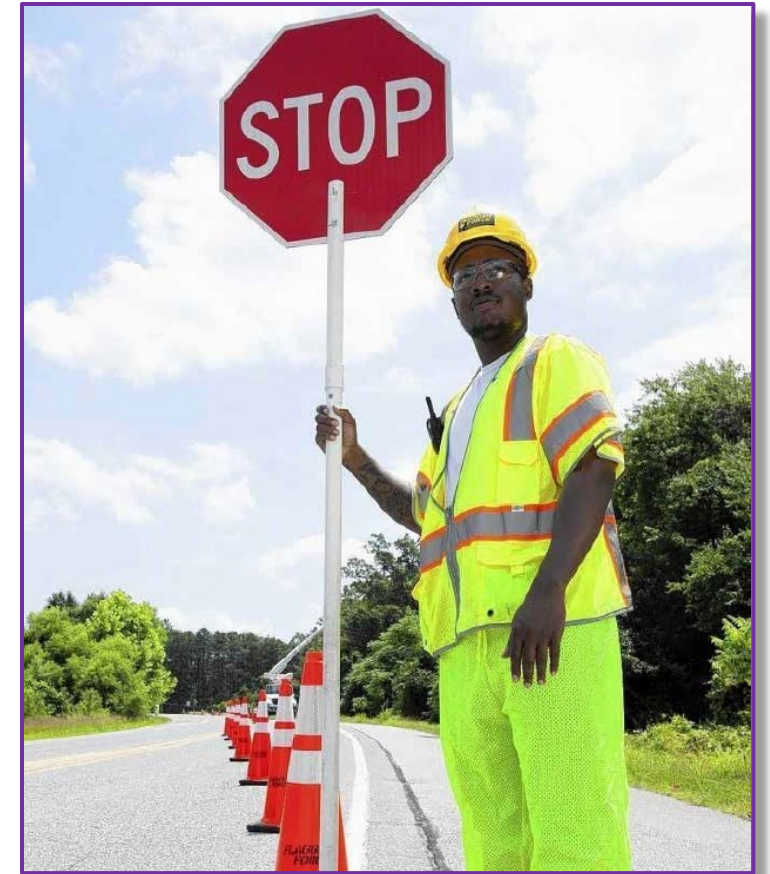



## CONSTRUCTION WORK HOURS

- Typical day shift: 7 a.m. – 5 p.m.
- Typical night shift: 7 p.m. – 4:30 a.m.
- Make-up / maintenance day will be Saturdays, as required
- The public will be notified through notifications on [purplelinemd.com](http://purplelinemd.com) for:
  - Utility shutdowns
  - Road/driveway closures
  - Pile driving
  - Night work
  - Weekend work
  - Major lane closures



## BUSINESS OUTREACH & COORDINATION

- The project's approach for business outreach consists of:
  - Engaging with those businesses potentially directly impacted by construction in the area
  - Understanding individual access and delivery requirements
  - Installation of “open for business” signage along the alignment
  - Coordination in English and Spanish (as needed)





## REVAMPED PURPLE LINE WEBSITE

- Redesigned website rolled out end of April 2019 that features:
  - New photo gallery of progress pictures and videos
  - New Factsheets
  - Landscape Plans
  - New FAQ Page
  - New Station Illustrations
  - Construction Updates
- Sign up to receive construction notifications via email or text

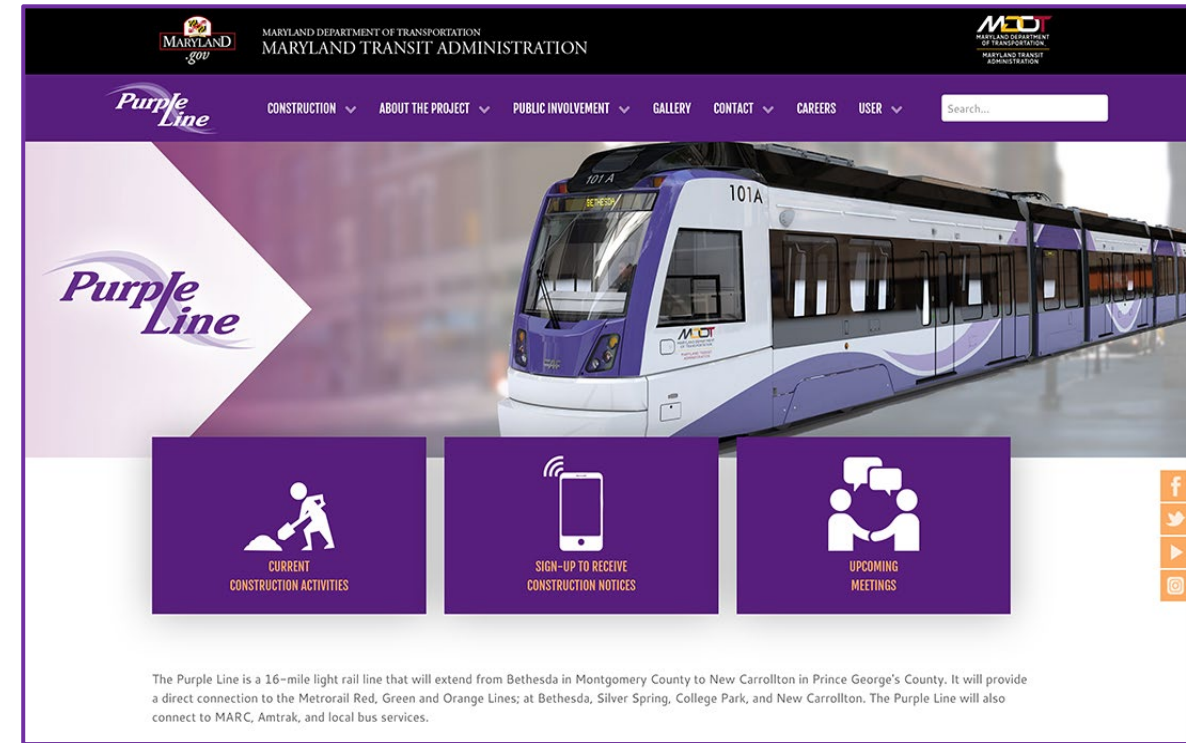



# STAY UP TO DATE ON PURPLE LINE PROGRESS

**Sign up for construction notices at [purplelinemd.com](https://purplelinemd.com)**

- For construction-related questions and concerns, contact PLTC
  - Email: [outreach@pltcllc.com](mailto:outreach@pltcllc.com)
  - 24/7 hotline at 240-424-5325
- For general project questions and comments, contact MDOT MTA public outreach
  - Email: [outreach@purplelinemd.com](mailto:outreach@purplelinemd.com)
  - Call: 443-451-3706 or 443-451-3705 (Para Español)